

Midwest® RDH®

Hygienist Handpiece with Prophyl Right Angle

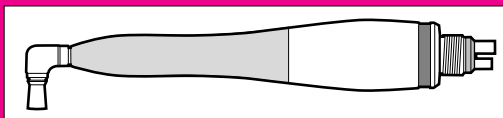

REF 740020 / REF 740030

Hygienist Handpiece with U-style Attachment

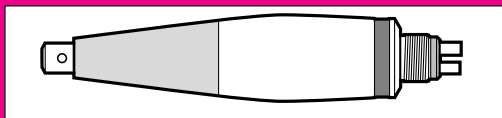

REF 740000 / REF 740010

Installation, Maintenance and Operation Instructions

MIDWEST

Indications For Use

Midwest RDH handpiece is used for low speed procedures performed by dental professionals.

Contraindications

None Known.

Warnings

STERILIZE BEFORE USE, SUPPLIED NON-STERILE.

WARNING: This product is intended for use by dental professionals only. Before operating handpiece, carefully read and follow these instructions and save them for future reference. Observe all cautions and warnings, including:

- Handpieces should be heat-sterilized between patients to prevent cross-contamination which could result in serious illness or even death from infectious organisms such as HIV (the virus that causes AIDS) or hepatitis B.
- It is the responsibility of the Dental Healthcare Professional to determine the appropriate use of this product and to understand the health of each patient, the dental procedures being undertaken, industry and governmental agency regulations, and recommendations and requirements for safe practice of dentistry.

Precautions

- Do not operate handpiece unless prophyl angle or cup is properly secured. A loose prophyl angle could eject from the handpiece and cause personal injury.
- Do not use angle, attachment or accessory that exhausts air within the oral cavity when a soft tissue wound is present. Air pressure may force septic materials into these tissues.

Adverse Reactions

None Known.

Installation

Checking Handpiece Hose

Make sure all tubes supplying the handpiece hose are properly connected within the dental unit. Test hose as follows:

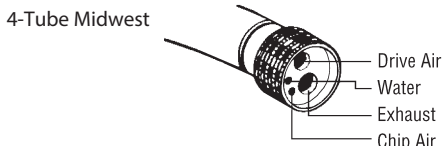

1. Hold free end of hose over cuspidor or towel while alternately depressing drive air pedal on foot control.

Note: The Midwest RDH Handpiece does not use chip-air or water spray. When connecting the Midwest RDH Handpiece, the water and chip air hose tubes can be disconnected and their supply connection plugged.

2. Check to be sure that drive air is coming out of the correct tube.

Air Requirements

Midwest RDH Handpieces deliver maximum speed and torque when operated with clean, filtered, moisture-free air at the recommended operating pressure of 30-40 p.s.i. Air pressure may be reduced to a minimum of 20 p.s.i. to decrease operating speed

Initial Maintenance

Follow the Maintenance procedure, at top of next column, before using your new Midwest RDH Handpiece.

Maintenance

Important: Use only Midwest® products recommended by DENTSPLY to routinely clean and lubricate your Midwest RDH Handpiece.

There are two Maintenance procedures for your RDH handpiece: (1) for maintenance using the Midwest Plus™ Maintenance Kit;

(2) for maintenance using Midwest Plus™ Aerosol Spray. Follow the appropriate maintenance procedure below before using your new RDH handpiece.

This procedure recommends the steps to follow between patient use to prevent cross-contamination and to ensure continued trouble-free operation of the handpiece:

1 Maintenance Using Midwest Plus™ Maintenance Kit

Clean External Surface

1. Remove prophyl cup by holding sheath of handpiece and rotating cup in counterclockwise direction.
2. Disconnect handpiece from its supply hose. Spray exterior surface of handpiece with Midwest Plus™ Handpiece Cleaner.
3. Scrub and rinse external surfaces of handpiece under warm tap water.
4. Thoroughly dry using gauze, paper towel or air syringe.

Lubricate and Expel

1. Place three drops of Midwest Plus Handpiece Lubricant into drive air tube (below).

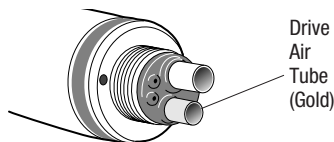

2. Run handpiece on Midwest Handpiece Air Station or other air source until it reaches normal speed. This ensures that the internal working parts of the motor are completely lubricated. Wipe off any excess lubricant on outside of handpiece with dry 2x2 or tissue.

3. Proceed to Sterilization.

2 Maintenance Using Midwest Plus™ Aerosol Spray

Scrub and Rinse

1. Remove prophyl cup by holding sheath of handpiece and rotating cup in counterclockwise direction.
2. Disconnect handpiece from its supply hose.
3. Scrub and rinse external surfaces of handpiece under warm tap water. Use sponge to scrub.
4. Dry thoroughly using gauze, paper towel or air syringe.

Clean • Lubricate • Expel

1. Clean and lubricate with one quick spray of Midwest Plus™ Aerosol Spray using the Midwest Backend Attachment nozzle into the drive air tube of the handpiece. The drive air tube is the shorter of the two larger tubes and is gold on many handpieces.
2. Run the handpiece on Midwest Handpiece Air Station or other air source for 30 seconds or until normal speed is reached, and all excess spray is expelled. Dry thoroughly.
3. Proceed to Sterilization.

Sterilization

Enclose the handpiece in a sterilization pouch intended for steam sterilization. Place the pouched handpiece into the steam sterilizer per the manufacturer's instructions.

Gravity Steam Sterilization

Full cycle: 121°C (250°F) for 30 minutes
Full cycle: 132 °C (270°F) for 15 minutes

Dynamic Air Removal

Full cycle: 132°C (270°F) for 4 minutes
Full Cycle: 135°C (275°F) for 3 minutes

Keep handpiece in sterilization pouch until ready to use in the operator. No further lubrication is required before use.

Other Maintenance

Weekly or as needed: Place two drops of lubricant on swivel junction (as shown). Twist swivel to work lubricant into junction. Wipe handpiece clean.

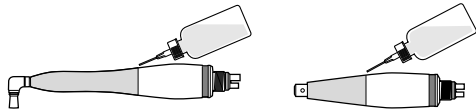

(FOR MIDWEST RDH WITH RIGHT ANGLE ATTACHMENT ONLY—REF 740020 / 740030)

Every 40 prophies, or once a week:

1. Unscrew angle from handpiece.
2. Place angle in beaker of Midwest Plus Handpiece Cleaner and ultrasonically clean for ten minutes.
3. Scrub and rinse under warm tap water.
4. Dry thoroughly.
5. Apply one drop of Midwest Plus Handpiece Lubricant on gears inside head. DO NOT fill head full, as excess lubricant will leak from seal.

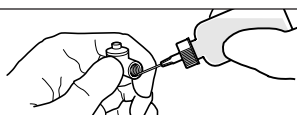

6. Apply one drop of Midwest Plus Handpiece Lubricant to gear teeth on handpiece sheath.

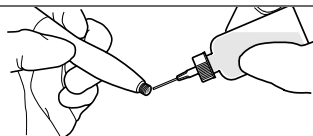

7. Reassemble and continue with "Sterilization" in the Maintenance procedure above.

Operation

To operate the handpiece, simply depress the foot control.

Note: Never operate air motor under the following conditions:

1. At air pressure exceeding 45 p.s.i. (3.1 Atm.).
2. On an alternate hose without adjusting air pressure.

Automatic Oilers

Since the use of automatic oiling does not eliminate the need for routine maintenance, the oiler should be disconnected. Do not use oil mist lubrication. (Excess oil may hinder performance.)

Speed Range

The Midwest RDH Handpiece offers exceptional torque at speeds up to 6000 RPM.

Mounting Disposable Propy Angles

(for Midwest RDH with Right Angle Attachment only—REF740020/740030)

A plastic head wrench has been provided for mounting or removing the prophy head.

To remove head: Place wrench over prophy head. Loosen head assembly by turning wrench counterclockwise. Unscrew and remove head with fingertips.

To install or replace head: Screw prophy head onto sheath assembly with fingers (clockwise). If the gears do not mesh properly, back head off 1/4 turn; then retighten. Lock head onto sheath by tightening with wrench.

Make sure prophy head is tightened securely before operating handpiece.

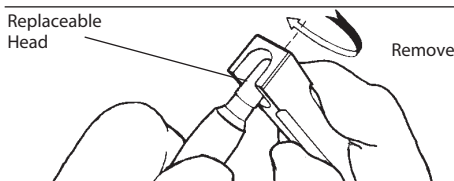

Mounting Disposable Propy Angles

(for Midwest RDH with U-Style Attachment only—REF740000/740010)

To mount disposable angle to handpiece: Push angle all the way into handpiece, making sure locating button on handpiece is seated into notch of angle.

To remove disposable angle from handpiece: Grasp handpiece with one hand and pull angle from handpiece with other hand.

Mounting Color Bands

To change the color code of the handpiece, remove the color band as shown, and replace it with a new band of the desired color.

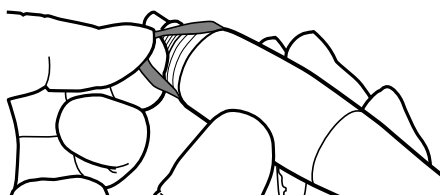

Repair

Midwest Air Repair™ Service

Should your Midwest RDH Handpiece need repair, call 1-800-800-7202 to schedule a free pick-up.



Send to:
Dentsply Sirona Midwest
Attn: Midwest Air Repair
901 West Oakton Street
Des Plaines, IL 60018-1884

Provide the following information

for your repair:

- Your complete name and address
- Dealer name and address
- Nature of repair

Air Repair offers:

- Repairs DOOR TO DOOR IN 2 BUSINESS DAYS
- Genuine Midwest Parts and DENTSPLY Quality
- Expert Troubleshooting and Diagnosis
- Repair Service Warranty equal to the new product warranty

Parts

REF

The Midwest RDH Hygienist handpiece is compatible with a wide range of disposable prophy angles and prophy cups/brushes.

Please see our website at dentsplysirona.com or contact your local Dentsply Sirona Customer Support Center.

Midwest Plus Maintenance Kit	8 oz. Spray Cleaner & 2 oz. Lubricant Dropper	380145
Midwest Plus Handpiece Cleaner	8 oz. Spray Bottle 1 Liter Refill Bottle	380140 380141
Midwest Plus	2 oz. Dropper Handpiece Lubricant	380130
Midwest Plus Aerosol Spray	Cleaner/Lubricant (does not include nozzle)	380080
Nozzle for Midwest Plus Aerosol Spray	Midwest Backend/ Attachment	380086
Midwest Handpiece Air Station	includes box of 12 FREE Spray Guards	380800
Midwest Spray Guards	Box of 100	380150
Spray Tips for Midwest Plus 8 oz. Spray Cleaner	pkg. of 6	380986
Prophy Head Wrench		230611
Color Bands, set of 6	Orange 760011R Yellow 760013R Blue 760015R	Red 760012R Violet 760014R Green 760016R

Warranty

Your Midwest RDH Handpiece is guaranteed to be free of defects in materials and workmanship for a period of two (2) years from its date of purchase — provided that the air motor has been operated and maintained as prescribed in these instructions (at the discretion of DENTSPLY Professional) and has not been subjected to apparent misuse, abuse or accident. All questionable, defective, or loose parts must be returned to the dealer, with air motor and proof of purchase, transportation prepaid.

The enclosed business reply card (guaranty registration) must be filled out completely and returned within ten (10) days of purchase for this guaranty to apply. DENTSPLY Professional makes no other guarantee, expressed or implied.

DENTSPLY
PROFESSIONAL

Covered by one or more of the following US patents:
DES 411,726, 6,012,922.
International patents pending.
Copyright 2017 Dentsply Sirona Preventive
Printed in U.S.A. Code No. 87126-1017

Manufactured by:
DENTSPLY Professional
1301 Smile Way
York, PA 17404, USA