

calm-it™

DESENSITIZER

Technique Guide

Direct Restorations



©2008 DENTSPLY International. All rights reserved. Form #51A001 (1/29/08)

1. If using a total etch adhesive system, apply the tooth conditioner to the tooth surface using the total etch technique described in manufacturer's Directions for Use. Do not apply the adhesive. Proceed to Step 2a or 2b.
NOTE: If using a total etch adhesive system, etching of the tooth surface must be completed prior to the use of Calm-it™ Desensitizer.

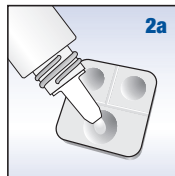

Shake bottle and dispense material into dispensing well
...OR

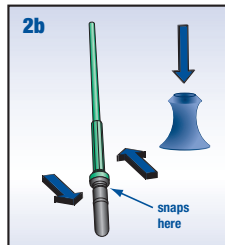

Grasp unit dose. Firmly apply pressure until the vial snaps open. Bend in the other direction to separate the brush. Place unit dose into the holder.

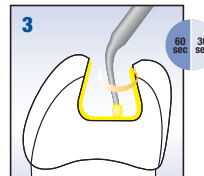

Immediately apply Calm-it™ Desensitizer to dentin for 30-60 seconds, using a gentle rubbing motion. The dentin should remain damp. Do not over-apply and avoid the contact of soft tissue.

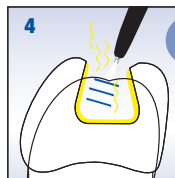

Remove excess by gently drying with clean, dry air from a dental syringe. Do not rinse or completely dry the surface.

5. Immediately apply adhesive as described in manufacturer's Directions for Use. **Do NOT re-etch if using a total etch adhesive system.**