

Spectra ST flow¹

Flowable Composite Restorative

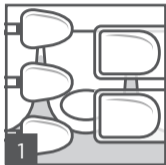

Shade Selection

Use the VITA^{®2} Shade Guide and i-shade label or the Spectra ST shade fingers.

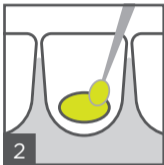

Conditioning and/or bonding

After shade selection apply adhesive according to the respective manufacturer's directions for use.

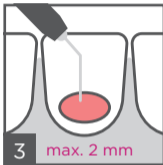

Placement of Restorative

Dispense material in up to 2 mm increments using slow, steady pressure. Avoid lifting the tip while dispensing to minimize air entrapment.

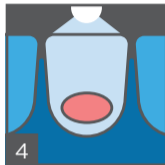

Light curing

Cure each 2 mm increment with a minimum irradiance of 550 mW/cm². Reference curing chart for appropriate curing time for each shade.

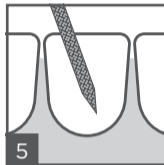

Shaping and contouring

With finishing diamond or carbide burs.

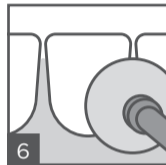

Finishing and polishing

Shape and contour, finish and polish (e.g. with Enhance[®] Finishing System and Enhance[®] PoGo[®] Polishing System).

¹ Depending on market location, Spectra ST flow is available as either TPH Spectra[®] ST flow, Ceram.x Spectra[™] ST flow, or Neo Spectra[™] ST flow.

² Not a registered trademark of Dentsply Sirona, Inc.



Caution, consult directions for use

Spectra ST flow¹

Flowable Composite Restorative





Shades available

Spectra ST flow

Universal CLOUD shades:
A1, A2, A3, A3.5, A4

Additional shades:
D1 and D3 (opaque dentin)
E1 (translucent enamel)
BW (Bleach White)

Curing Chart

Shade	 mW/cm ²	 sec	 mm
A1 - A4 BW	≥ 550	20	2
	≥ 800	10	
D1, D3	≥ 550	40	2
	≥ 800	30	
E1	≥ 550	10	2

i-shade label

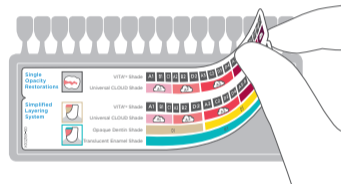

Stick i-shade label to VITA^{®2} Shade Guide

Shade Guide

VITA ^{®2} Shade	A1	B1	C1	A2	B2	D2	A3	C2	D3	D4	A3.5	B3	B4	C3	A4	C4	+	D1, D3, E1, BW (Bleach White)
Universal CLOUD Shade	A1		A2			A3			A3.5			A4						