

Calibra® Abutment Resin Cement

Extraoral Cementation of Abutment Restoration to TiBase

1. HIGH STRENGTH GLASS CERAMIC RESTORATION PREPARATION

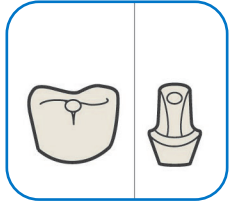

- 1.1.** Prepare the abutment or restoration according to the manufacturer's Instructions for Use.

Note: Ensure the ceramic structure can be fully inserted onto the TiBase. The shoulder of the abutment must contact the TiBase flange without perceptible gap.

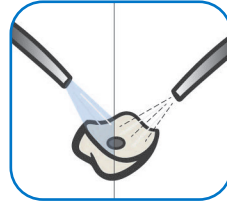

- 1.2.** Apply 5% to 9% hydrofluoric acid etching gel (available separately, see complete Instructions for Use) to the bonding surface of the restoration only. Do not allow etchant into the screw channel. Etch for 30 seconds.
- Apply Calibra® Silane Coupling Agent (sold separately, see complete Instructions for Use) only to surfaces that are required for adhesive cementation. Allow to react for 60 seconds.

2. TIBASE PREPARATION

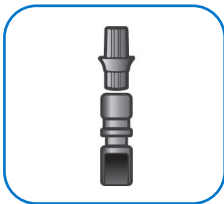

- 2.1.** Attach the TiBase to the implant analogue or polishing tool using screw.

Cover the hex head of the abutment screw and fill the screw channel with easily removable material (e.g., soft wax, impression material, cotton or plumber's tape).



- 2.2.** Sandblast only the surface of the TiBase intended for cementation (50um aluminum oxide, max 2.0 bar).

Note: Do not sandblast the polished tissue surface of the flange.



- 2.3.** Clean the TiBase with alcohol, ultrasonic, or steam. Dry with clean, oil-free air.

3. CEMENTATION



- 3.1.** Dispense and discard a small amount of material from the dual-barreled syringe. Attach mixing tip and gently extrude product.

Note: The ultra opaque shade is optimized for blocking of metal show-through.

Material is designed to be self-cure only. For extraoral cementation.

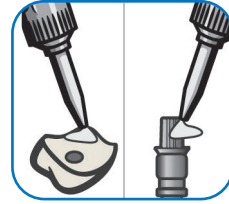

- 3.2.** Apply a uniform layer of the cement to the bonding surfaces of the TiBase and the restoration. Prevent the cement from entering the restoration screw channel.

Seat restoration onto TiBase within 2 minute working time from start of mix.

Note: Cover the hex head of the abutment screw and fill the screw channel with easily removable material (e.g., soft wax).

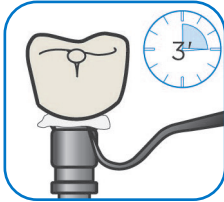

- 3.3.** Stabilize the restoration with gradual pressure. Remove excess cement during "gelled" state (3 minutes from start of mix) by wiping with a soft tissue, cotton, or similar material. Ensure there's no cement excess in the screw channel.

Complete excess cement removal using an instrument such as a rubber tip, a scaler, or an explorer.

Protect assembly from contamination and movement until the final set of the cement (see complete Instructions for Use).

Apply water-soluble air barrier to the cement margin.

Note: Cement within the restoration has not yet set. Do not move, torque, or disturb the restoration during cleanup.

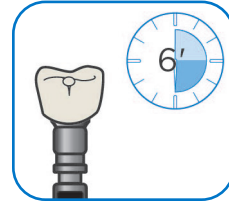

- 3.4.** Ensure margin between TiBase and restoration is closed and sealed. Protect assembly from contamination and allow cement to self-cure without movement until the final set of cement (6 minutes from start of mix).

4. FINAL RESTORATION



- 4.1.** Rinse air barrier material under running water.

Remove wax or other sealing material and any residual cement from the screw channel. Remove any cement at the margin. Finish and polish the margin using rubber rotary tools.

Note: Clean, disinfect and sterilize the final restoration before delivery.



www.dentsplysirona.com/ifu